

CIRCUIT SIZE	DIM A	DIM C	DIM E
2	3.00	6.85	9.74
3	6.00	9.85	12.74
4	9.00	12.85	15.74
5	12.00	15.85	18.74
6	15.00	18.85	21.74
7	18.00	21.85	24.74
8	21.00	24.85	27.74
9	24.00	27.85	30.74
10	27.00	30.85	33.74
11	30.00	33.85	36.74
12	33.00	36.85	39.74

0.2 MAX SINK
ALLOWED ON THIS
SIDE OF TPA

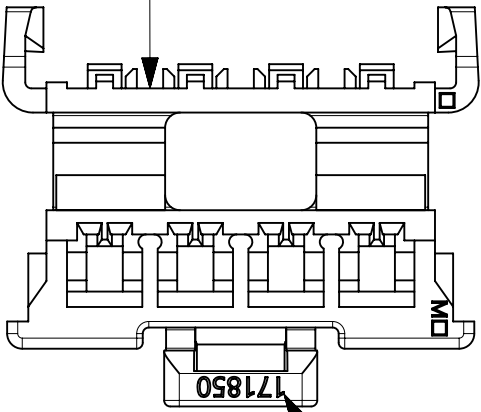

MOLEX SERIES ID

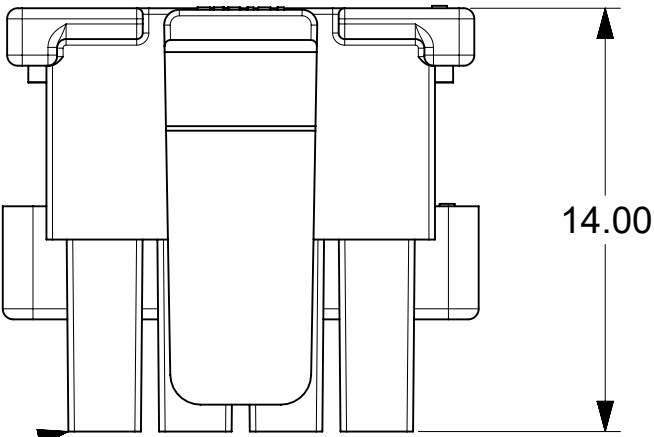

CKT 1

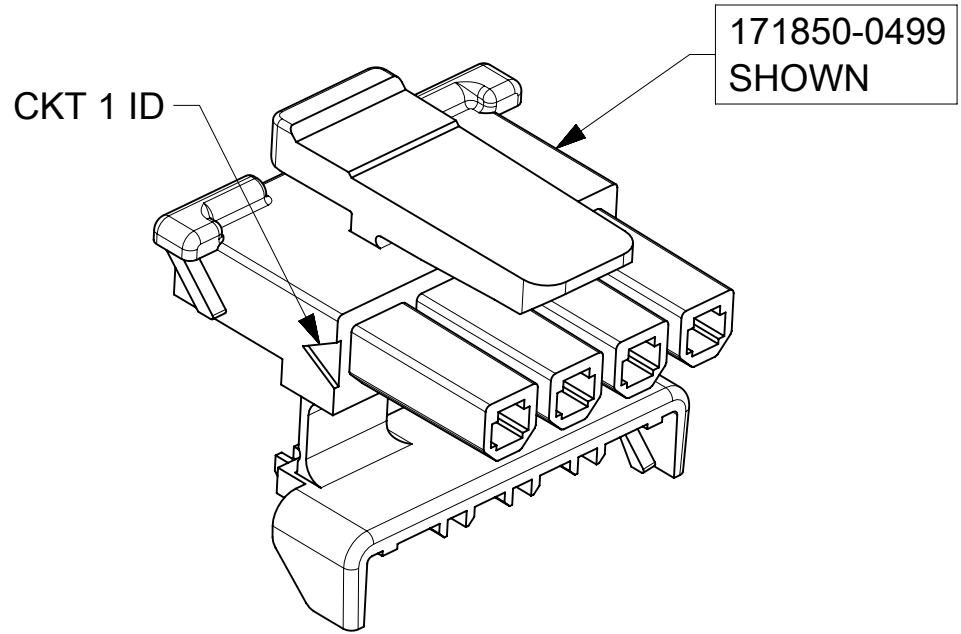
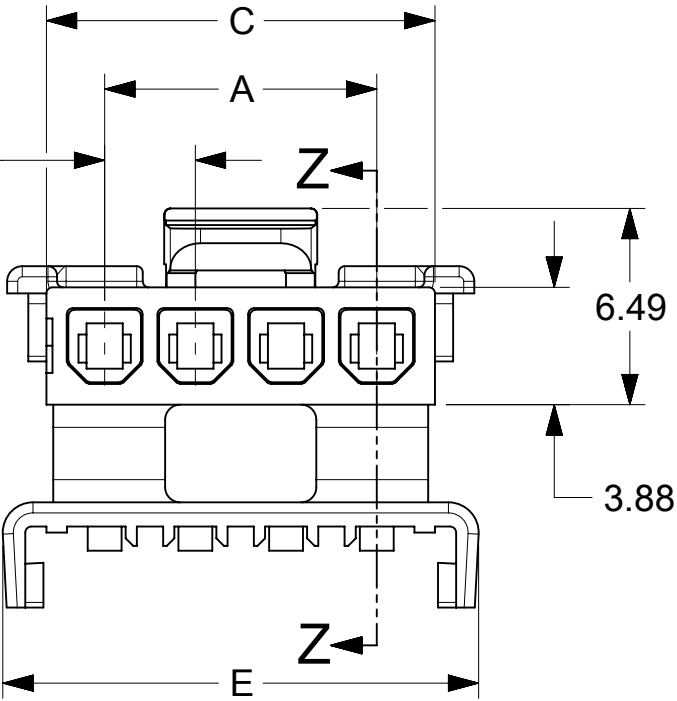

NOTES:

- MATERIAL:
A = NYLON V-0 LOW HALOGEN, COLOR: BLACK
B = NYLON, V-0, GLOW WIRE IEC 60335-1 GLOW WIRE CAPABLE, COLOR: BLACK
- FINISH: NONE
- PRODUCT SPECIFICATION: PS-43650
- PACKAGING SPECIFICATION: 1718500001-RPK
- THIS HOUSING TO BE USED WITH MOLEX FEMALE TERMINAL 43030 OR 46235 SERIES.
- THIS PART MATES WITH 43640 AND 43650.
- THIS PART CONFORMS TO CLASS 'B' REQUIREMENTS OF COSMETIC SPECIFICATION PS-45499-002.
- REFER TO AS-45499-001 FOR MOISTURIZING NYLON CONNECTOR PARTS.
- PRODUCT MUST BE USED WITH TPA INSTALLED.
- TPA IS INTENDED FOR ONE TIME USE.
- INTENDED FOR USE WITH 20-30 AWG WIRES ONLY.
- SOME HOUSINGS MAY HAVE A SMALL GATE BLEMISH NEAR THE GATE THAT DOES NOT AFFECT FUNCTIONALITY.
- MOLEX RECOMMENDS THE USE OF MICRO-FIT TEST PLUG, SERIES NO. 44242-**** WHENEVER TESTING IS PERFORMED. TEST PLUGS MUST NOT BE USED FOR MAKE OR BREAK UNDER LOAD. MOLEX DOES NOT RECOMMEND USING STANDARD MATING COMPONENTS FOR HARNESS TESTING PURPOSES.
- TEXT ON PART IS FOR REFERENCE ONLY. TEXT AND TEXT LOCATION MAY VARY DEPENDING ON PART NUMBER AND/OR TOOL.

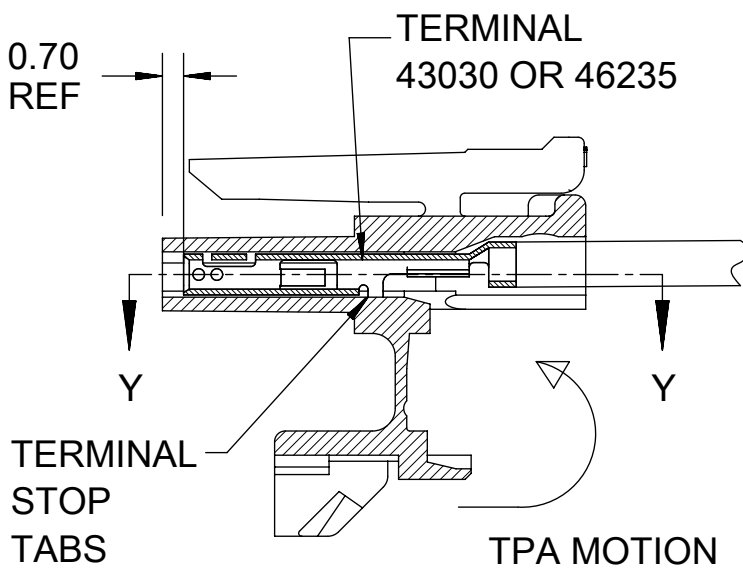

SECTION Z-Z

TPA OPEN

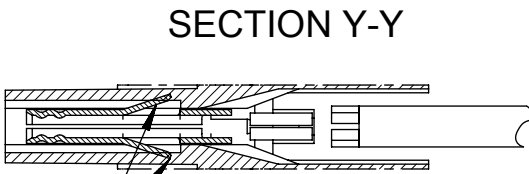

SECTION Y-Y
TERMINAL LOCKING TANGS
SHOULD BE FULLY SEATED
IN HOUSING BEFORE ACTIVATING
THE HINGED TPA

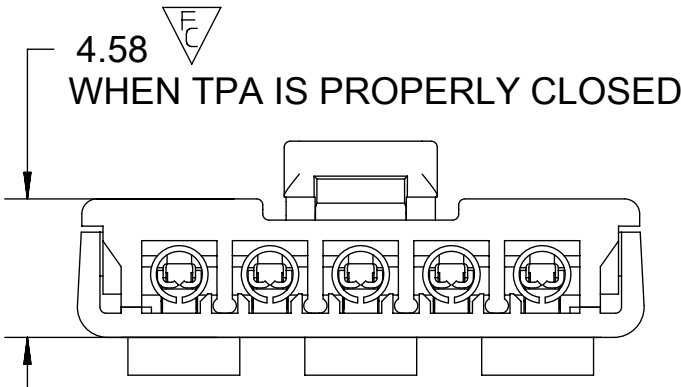
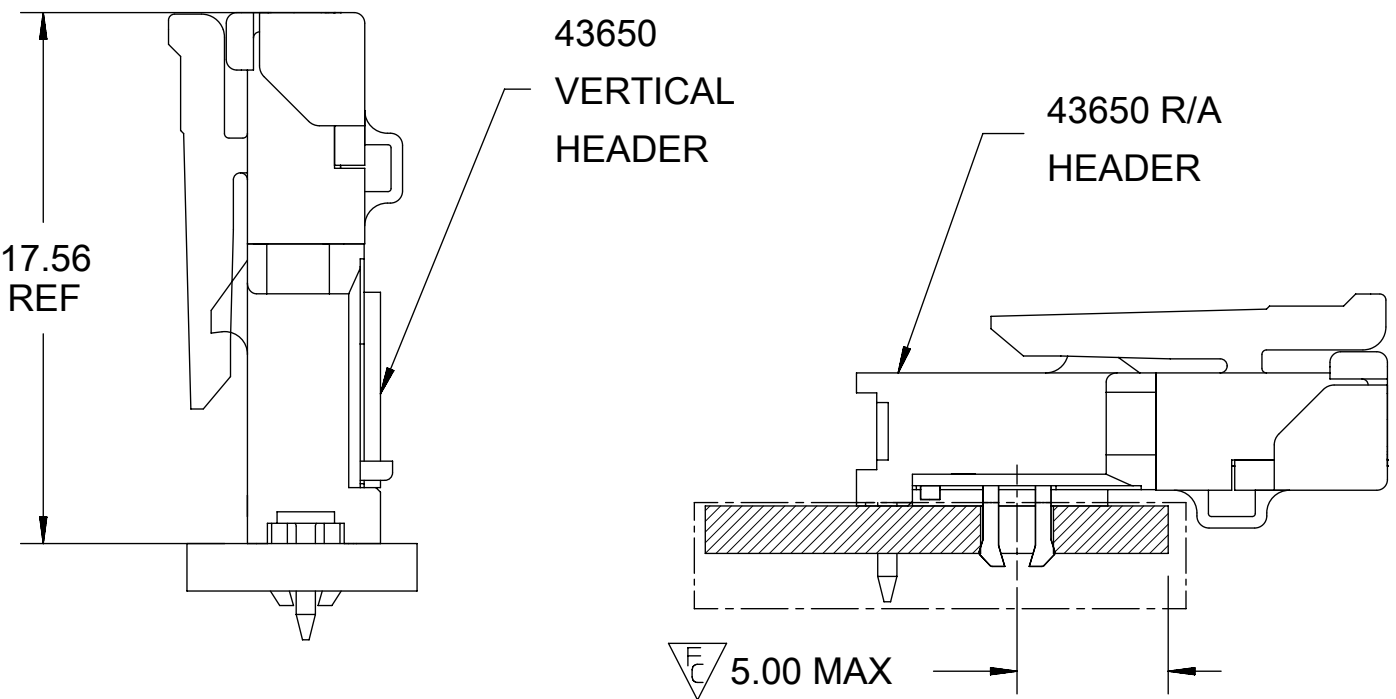

TPA CLOSED

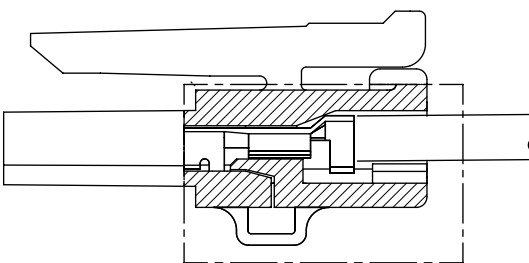
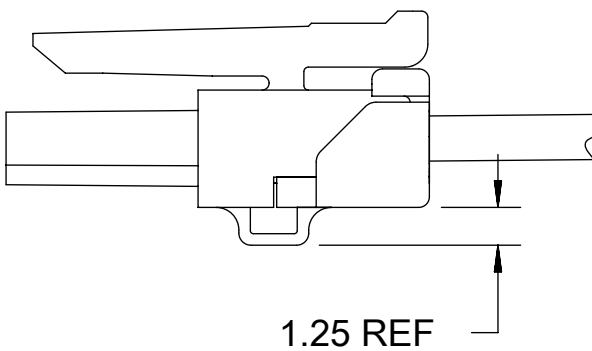

THIS DRAWING CONTAINS INFORMATION THAT IS PROPRIETARY TO MOLEX ELECTRONIC TECHNOLOGIES, LLC AND SHOULD NOT BE USED WITHOUT WRITTEN PERMISSION																	
DIMENSION UNITS		SCALE		CURRENT REV DESC:				<div>molex</div>									
mm		NTS															
GENERAL TOLERANCES (UNLESS SPECIFIED)																	
ANGULAR TOL		±	°					EC NO: 781842									
4 PLACES		±						DRWN: JERRYW8		2023/10/11							
3 PLACES		±		CHK'D: XQZHANG		2024/04/02											
2 PLACES		±	0.25	APPR: XQZHANG		2024/04/02		MICRO-FIT(3.0) SINGLE ROW TPA RECEPTACLE									
1 PLACE		±		INITIAL REVISION:													
0 PLACES		±		DRWN: RICARC13		2022/09/15		DOCUMENT NUMBER		DOC TYPE	DOC PART	REVISION					
DRAFT WHERE APPLICABLE MUST REMAIN WITHIN DIMENSIONS				THIRD ANGLE PROJECTION		DRAWING		SERIES		MATERIAL NUMBER		CUSTOMER		SHEET NUMBER			
						C-SIZE		171850		SEE CHART		GENERAL MARKET		1 OF 2			
										1718500001-RSD		PSD		000		A1	

	12		11		10		9		8		7		6		5		4		3		2		1
TOOLED		PART NUMBER		CIRCUIT SIZE		MATERIAL (SEE NOTE 1)																	
NO				12		A LOW HALOGEN																	
				11																			
				10																			
				9																			
YES		171850-0899		8																			
				7																			
				6																			
				5																			
YES		171850-0499		4																			
				3																			
YES		171850-0299		2																			
				12		B GLOW WIRE																	
				11																			
				10																			
				9																			
YES				8																			
				7																			
				6																			
				5																			
YES				4																			
				3																			
YES				2																			

CUSTOM POLARIZATION LAYOUT

CUSTOM POLARIZATION LAYOUT

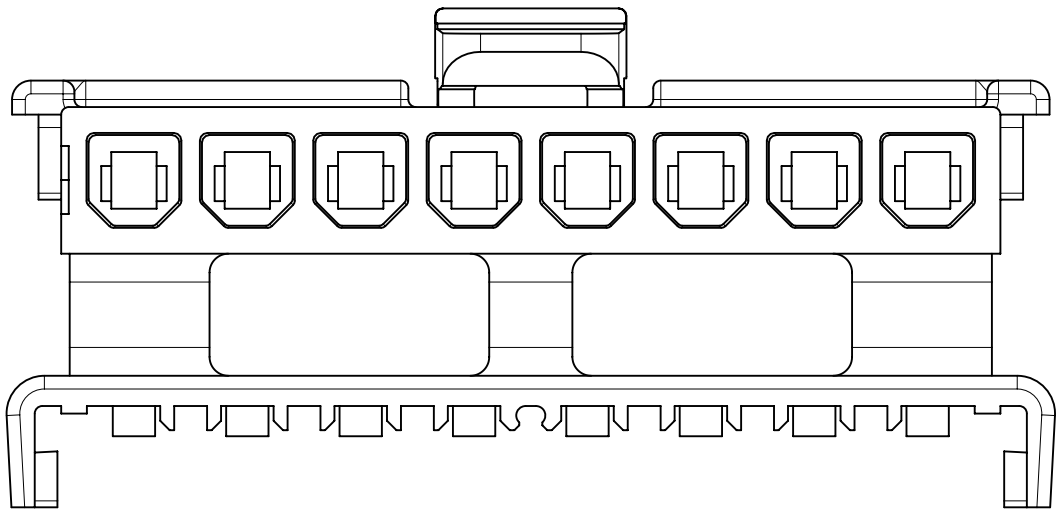
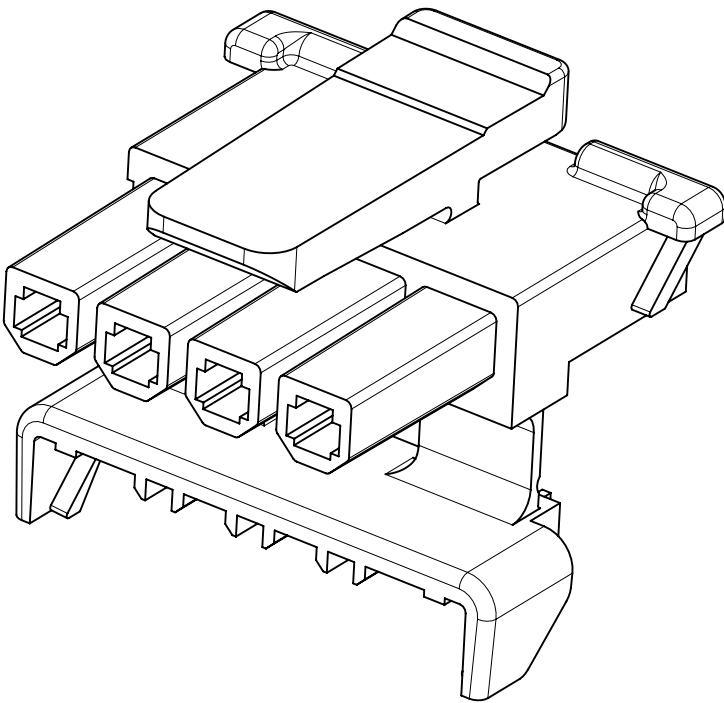

8 CKT

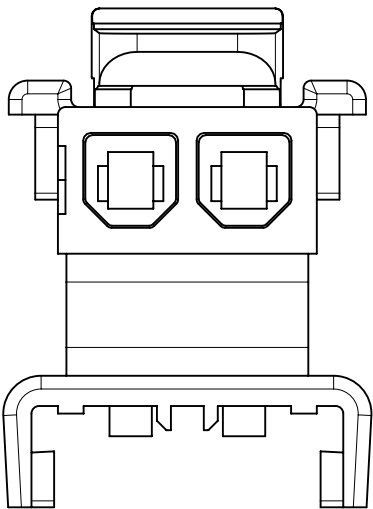

2 CKT

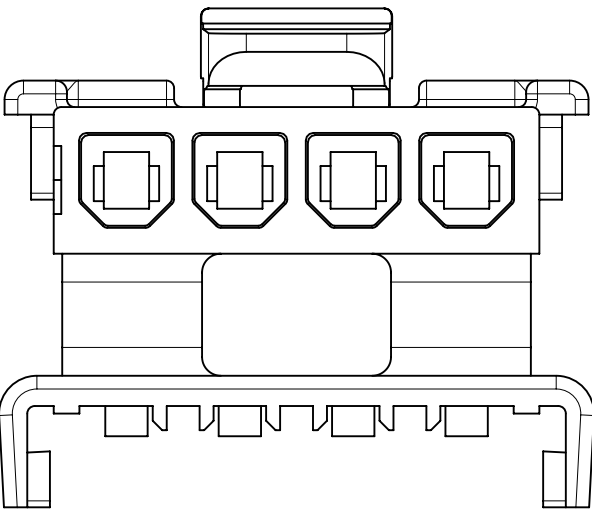

4 CKT

THIS DRAWING CONTAINS INFORMATION THAT IS PROPRIETARY TO MOLEX ELECTRONIC TECHNOLOGIES, LLC AND SHOULD NOT BE USED WITHOUT WRITTEN PERMISSION

DIMENSION UNITS	SCALE	CURRENT REV DESC:		<div>molex</div>					
mm	NTS								
GENERAL TOLERANCES (UNLESS SPECIFIED)									
ANGULAR TOL	± °			MICRO-FIT(3.0) SINGLE ROW TPA RECEPTACLE					
4 PLACES	±	EC NO: 781842 DRWN: JERRYW8 CHK'D: XQZHANG APPR: XQZHANG		2023/10/11 2024/04/02 2024/04/02		PRODUCT CUSTOMER DRAWING			
3 PLACES	±								
2 PLACES	± 0.25								
1 PLACE	±	INITIAL REVISION: DRWN: RICARC13 APPR: XQZHANG		2022/09/15 2024/04/02		DOCUMENT NUMBER	DOC TYPE		
0 PLACES	±					1718500001-RSD	PSD		
DRAFT WHERE APPLICABLE MUST REMAIN WITHIN DIMENSIONS		THIRD ANGLE PROJECTION	DRAWING	SERIES	MATERIAL NUMBER	CUSTOMER	SHEET NUMBER		
			C-SIZE	171850	SEE CHART	GENERAL MARKET	2 OF 2		