

12		11	10	9	8	7	6	5	4	3	2	1
MAT'L NO	ENG NO	CARRIER										
197054303	19705-4303	STRIP WITH INTERLEAF PAPER										
197050004	19705-0004	STRIP WITHOUT INTERLEAF PAPER										
197054301	19705-4301	LOOSE										

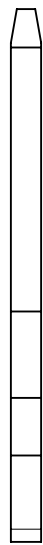

J1 PCB HOLE LAYOUT

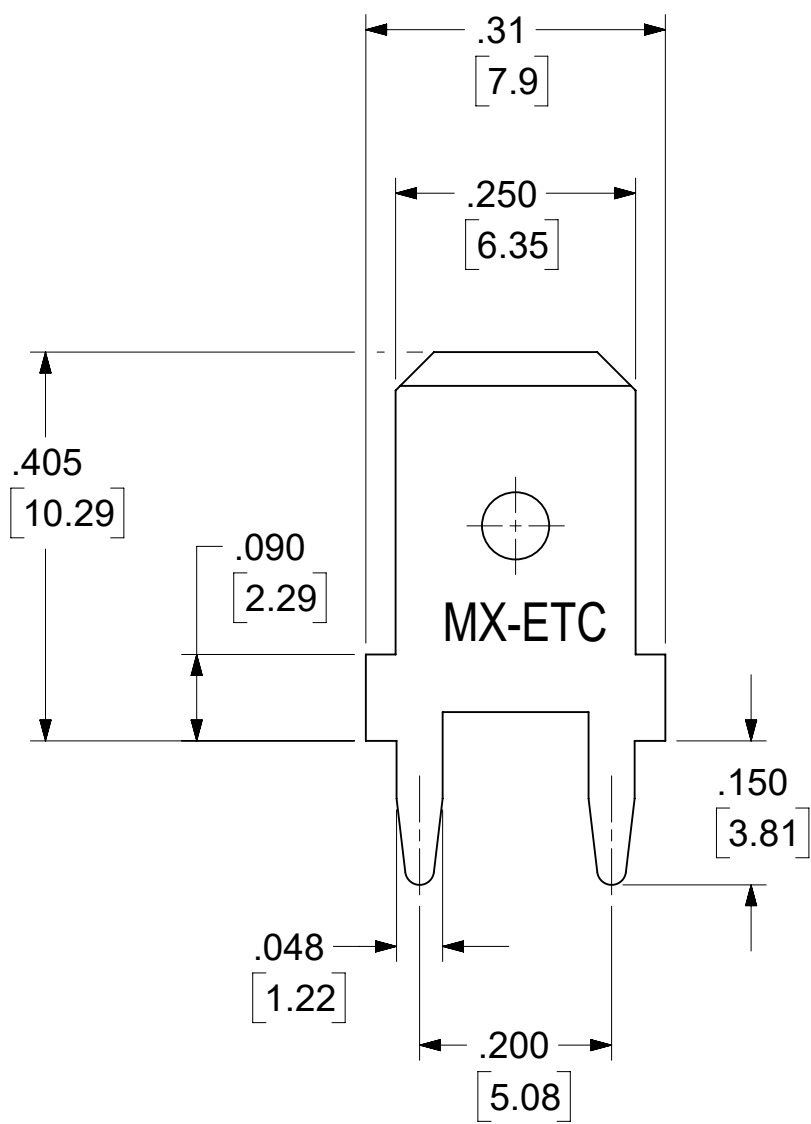
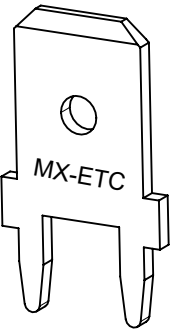
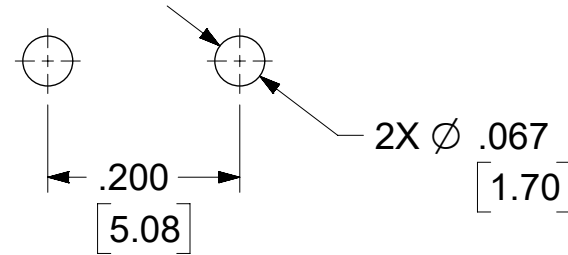

SCALE 3:1

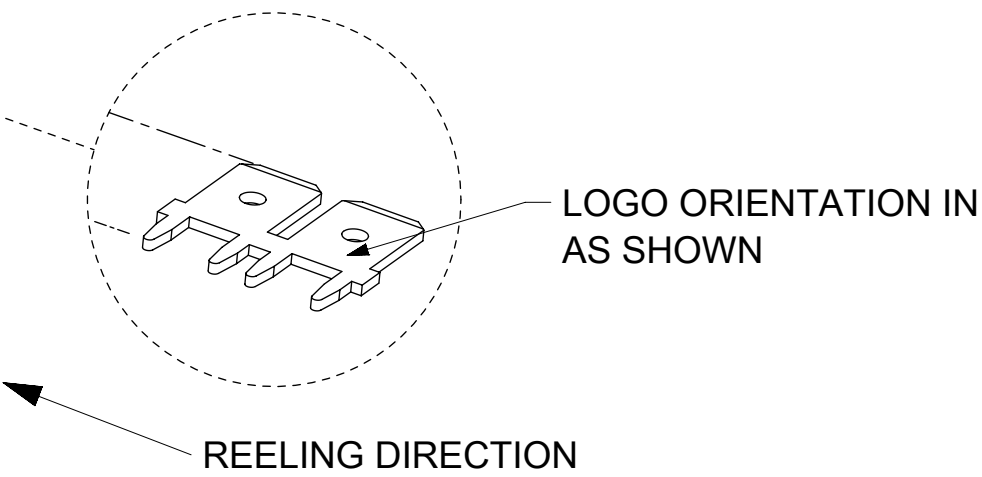
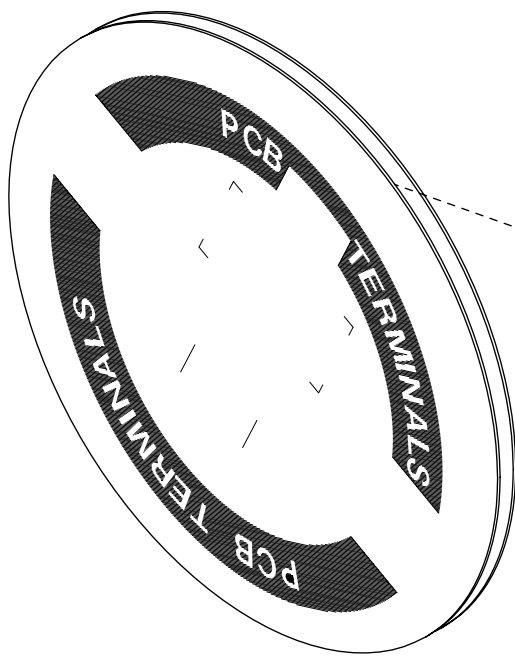
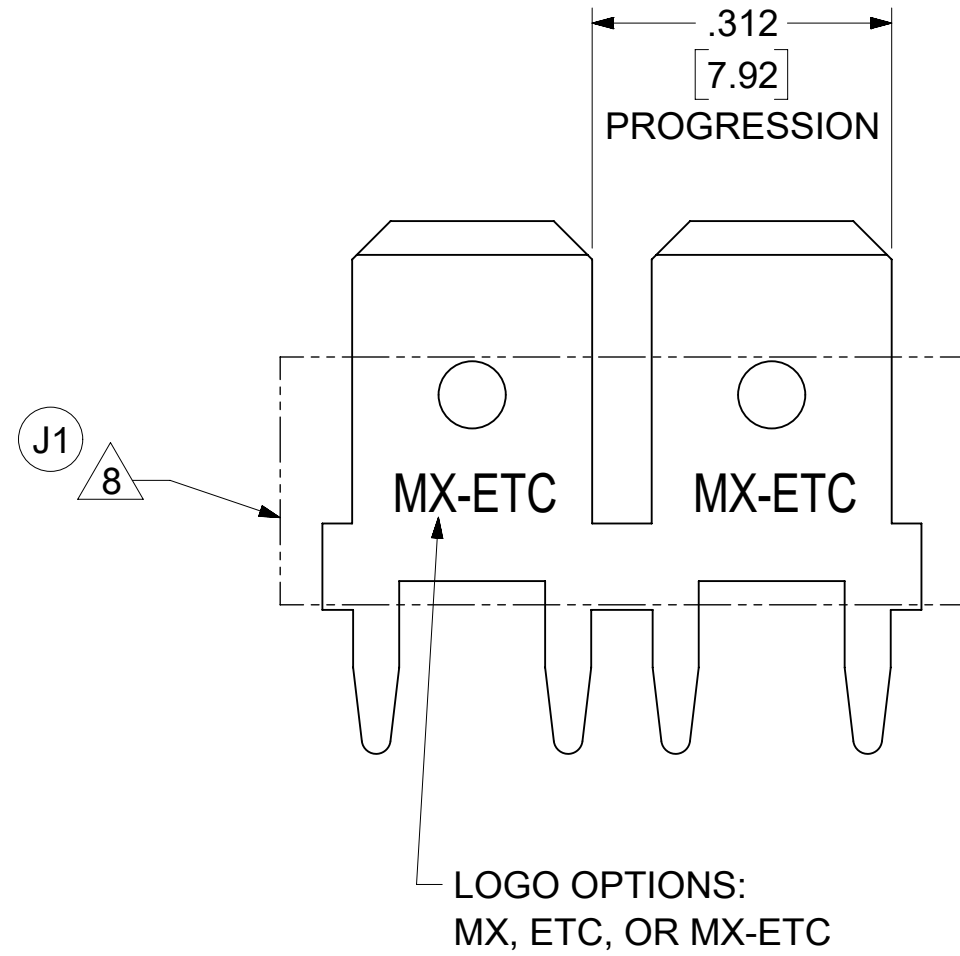

REELING DIRECTION

NOTES:

1. BARE EDGES PERMISSIBLE AT CARRIER CUT-OFF.
2. MATERIAL: BRASS C26000, .032 (0.81) THICK.
3. TAB CONFORMS TO NEMA SPECIFICATIONS.
4. ALL DIMENSIONS AND NOTES REFERENCE UNLESS OTHERWISE NOTED.
5. PLATING: MATTE TIN 150 µIN (3.81 µmm) MINIMUM THICKNESS OVER NICKEL 50 µIN (1.25 µmm) MINIMUM THICKNESS.
6. REF: 9,000 MIN PARTS PER REEL, 14" DIA REEL WITH 1.25" DIA CENTER HOLE.
7. MUST BE RoHS COMPLIANT.
8. REDUCED PLATING THICKNESS PERMISSIBLE IN THIS AREA.

FUNCTIONAL SYMBOLS <div>F A</div> = 0 <div>F C</div> = 0 <div>F D</div> = 0 DIVISIONAL SYMBOLS	THIS DRAWING CONTAINS INFORMATION THAT IS PROPRIETARY TO MOLEX ELECTRONIC TECHNOLOGIES, LLC AND SHOULD NOT BE USED WITHOUT WRITTEN PERMISSION											
	DIMENSION UNITS		SCALE		CURRENT REV DESC: REDRAWN TO NX, REMOVED "RECOMMENDED", ADDED REDUCED PLATING NOTE				<div>molex</div>			
	INCH/MM		5:1									
	GENERAL TOLERANCES (UNLESS SPECIFIED)				EC NO: 764133 DRWN: DEANNM1 2023/09/18 CHK'D: ETHRODAHL 2023/09/28 APPR: ETHRODAHL 2023/09/28							
		MM	INCH									
	4 PLACES	±		±	INITIAL REVISION: DRWN: BDEROSS 2000/08/24 APPR: RDEROSS 2000/08/28							
	3 PLACES	±		± 0.005								
	2 PLACES	±	0.13	± 0.01	DOCUMENT NUMBER SD-19705-430 DOC TYPE PSD DOC PART 001 REVISION J1							
	1 PLACE	±	0.25	±								
	0 PLACES	±		±	MATERIAL NUMBER CUSTOMER GENERAL MARKET SHEET NUMBER 1 OF 1							
	ANGULAR TOL ± 0.5 °											
DRAFT WHERE APPLICABLE MUST REMAIN WITHIN DIMENSIONS				THIRD ANGLE PROJECTION		DRAWING C-SIZE	SERIES 19705					

DOCUMENT STATUS	P1	RELEASE DATE	2023/09/28	18:52:24	9	8	7	6	5	4	3	2	1
-----------------	----	--------------	------------	----------	---	---	---	---	---	---	---	---	---