

# HC-A 4-ESTS - Contact insert

1774911

<https://www.phoenixcontact.com/us/products/1774911>



Please be informed that the data shown in this PDF document is generated from our online catalog. Please find the complete data in the user documentation. Our general terms of use for downloads are valid.



HEAVYCON male insert, A4 series, 4-pos., screw connection without wire protection, with IP65 sealing screw

## Commercial data

Item number	1774911
Packing unit	1 pc
Note	Made to order (non-returnable)
Sales key	BF61
Product key	BF7ABB
Catalog page	Page 405 (C-4-2013)
GTIN	4017918122249
Weight per piece (including packing)	16.9 g
Weight per piece (excluding packing)	15.23 g
Customs tariff number	85366990
Country of origin	DE

# HC-A 4-ESTS - Contact insert

1774911

<https://www.phoenixcontact.com/us/products/1774911>



## Technical data

### Notes

General	for housing HC-D7
---------	-------------------

### Mounting

Assembly note	Connectors may be operated only when there is no load/voltage. Already includes one IP65 sealing screw
---------------	---

### Product properties

Product type	Contact insert with a fixed no. of positions
Series	HC-A
Type	D7
Number of positions	4
Connection profile	4+PE
Contact numbering	1 - 4

### Insulation characteristics

Overvoltage category	III
Degree of pollution	3

### Dimensions

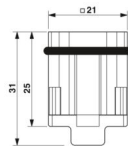
Dimensional drawing	
Height	30 mm

### Connection data

#### Connection technology

Connection technology	Screw connection
Connection in acc. with standard	IEC / EN

#### Conductor connection

Conductor cross section	0.5 mm <sup>2</sup> ... 1.5 mm <sup>2</sup> (applies to stranded conductors with ferrules)
Connection cross section AWG	20 ... 16
Tightening torque	0.25 Nm
Stripping length of the individual wire	5 mm

### Electrical properties

Rated voltage (III/3)	230 V (Conductor-PE)
	400 V (Conductor-Conductor)
Rated voltage for power contacts	230/400 V

# HC-A 4-ESTS - Contact insert



1774911

<https://www.phoenixcontact.com/us/products/1774911>

Rated surge voltage	4 kV
	4 kV
Rated current	16 A
Test voltage	4 kV AC

## Mechanical properties

### Mechanical data

Insertion/withdrawal cycles	≥ 500
-----------------------------	-------

## Material specifications

Flammability rating according to UL 94	V0
Seal material	NBR
Contact material	Copper alloy
Contact surface material	Ag
Contact carrier material	PA

## Environmental and real-life conditions

### Ambient conditions

Ambient temperature (operation)	-40 °C ... 125 °C (including heating up of contacts)
---------------------------------	--

## Standards and regulations

Constructional and testing regulations	IEC 61984:2008
	IEC 60664-1:2007
	IEC 60664-1, DIN IEC 60512
Tests	IEC 61984:2008
	IEC 60664-1:2007
	IEC 60664-1, DIN IEC 60512

## Drawings

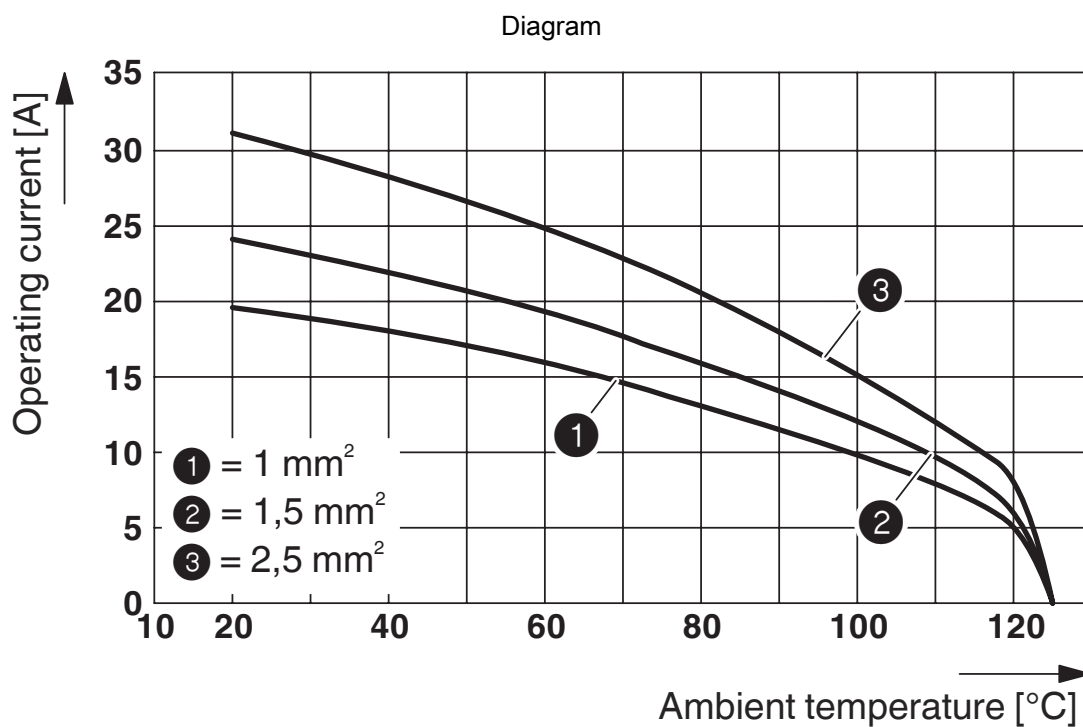

Derating diagram: Series HC-A 3-E..S / HC-A 4-E..S

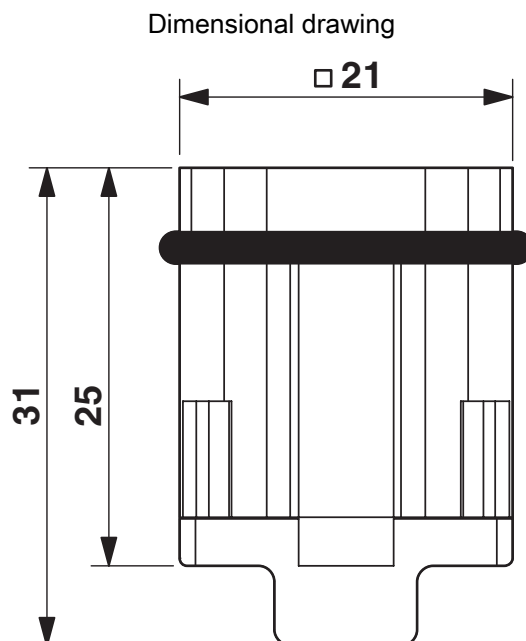

Male insert

# HC-A 4-ESTS - Contact insert

1774911

<https://www.phoenixcontact.com/us/products/1774911>

Schematic diagram

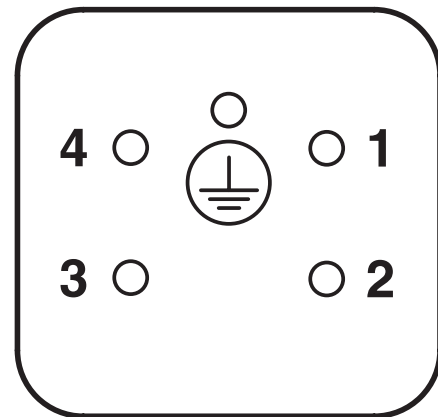
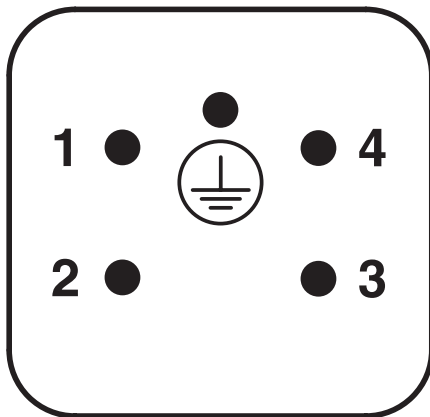

Connector pin assignment connection side: Left pin; right socket

# HC-A 4-ESTS - Contact insert

1774911

<https://www.phoenixcontact.com/us/products/1774911>



## Classifications

### ECLASS

ECLASS-11.0	27440205
ECLASS-13.0	27440205

# HC-A 4-ESTS - Contact insert



1774911  
<https://www.phoenixcontact.com/us/products/1774911>

## Environmental product compliance

EU RoHS	
Fulfills EU RoHS substance requirements	Yes, No exemptions
China RoHS	
Environment friendly use period (EFUP)	EFUP-E
	No hazardous substances above the limits
EU REACH SVHC	
REACH candidate substance (CAS No.)	No substance above 0.1 wt%

Phoenix Contact 2024 © - all rights reserved  
<https://www.phoenixcontact.com>

Phoenix Contact USA  
586 Fulling Mill Road  
Middletown, PA 17057, United States  
(+717) 944-1300  
[info@phoenixcon.com](mailto:info@phoenixcon.com)